



A Modern Oasis in the Heart of Nature

Immerse yourself in the harmonious fusion of nature and contemporary elegance at Site 338, Halcyon Greens. This exquisite property, set within the prestigious over-50s community of Halcyon Greens, offers a unique opportunity to experience modern luxury amidst serene natural beauty.

This thoughtfully designed home presents a sophisticated take on modern luxury featuring a well-appointed 186 sqm layout on a spacious 270 sqm site. Step through the inviting front entrance and be greeted by a light-filled porch and a secure, three-point locking system on the stainless-steel security door.

Inside, you'll find an open-plan living area with a striking 4-meter raked ceiling that extends to the rear patio, creating an expansive sense of space. With split system air-conditioning and ceiling fans throughout, the home provides comfort in every season. The living and dining areas are well-defined, while the kitchen boasts high-end Franke cooking appliances, an induction cooktop, and a Westinghouse dishwasher. Neutral tiles flow through the main areas, with plush carpet softening the bedrooms and study/multipurpose room.

The master suite features a walk-in robe and private ensuite, while the second bedroom, located near the main bathroom, provides convenience and comfort. A super-sized laundry offers direct access to the drying court, enhancing practicality. Outdoors, the extended rear patio is ideal for entertaining, complete with remote privacy blinds, extra decking, and a charming garden with a water feature. The 1.5-car garage offers ample storage space, making this home as functional as it is beautiful.

Experience the unparalleled lifestyle offered at Halcyon Greens, where comfort, security, and natural beauty come together in an exclusive, over-50s community. This thoughtfully crafted home on Site 338 invites you to embrace a new way of living, surrounded by lush landscapes and modern conveniences.



338/7 HALCYON DRIVE
PIMPAMA

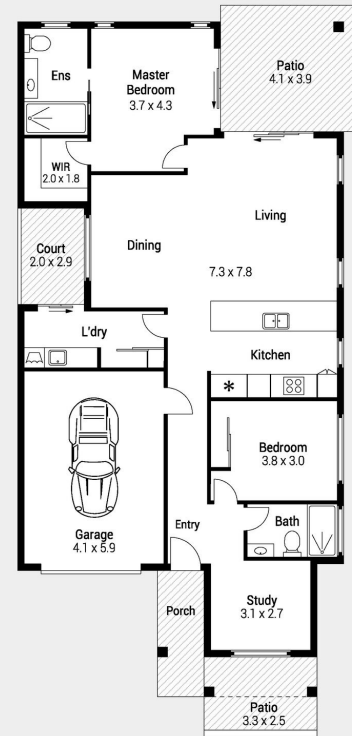

| | |
|--------------|----------------------------|
| Internal | : 123 m ² |
| Garage | : 26 m ² |
| Patio | : 16 m ² |
| Porch | : 15 m ² |
| Court | : 6 m ² |
| Total | : 186 m² |

Indicative only. Dimensions are approximate. All information contained herein is gathered from sources we believe to be reliable. However, we cannot guarantee its accuracy and interested persons should rely on their own enquiries.

Features of the Home

- Spacious 270 sqm site with a 186 sqm modern home design
- 1.5-car garage with additional storage space
- Light-filled front porch with secure, three-point locking system
- Expansive 4-meter raked ceiling in living area and rear patio
- Split system air-conditioning and ceiling fans throughout
- High-end Franke appliances, induction cooktop, and Westinghouse dishwasher
- Private master suite with walk-in robe and ensuite
- Second bedroom located near main bathroom for added convenience
- Extended rear patio with privacy blinds and additional decking
- Beautifully landscaped garden with water feature and power points for lighting

338/7 Halcyon Drive, Pimpama



For Sale

Offers Over \$945,000

Inspection by appointment



Contact
 Lisa Ashton
 0419 601 760
 lisa.ashton@stockland.com.au

Floorplans and elevations are for illustrative purposes only. Whilst all care has been taken in the preparation of the particulars contained herein, no warranty can be given and interested parties must therefore rely on their own enquiries. Note: Drawing is not to scale.